



超小型钮子开关 Sub-Miniature Toggle Switch

技术特性 Specifications

- 1. 规格 Rating: 3A 125VAC; 1.5A 250VAC
- 2. 接触电阻 Contact Resistance: 20mΩ max
- 3. 绝缘电阻 Insulation Resistance: 500VDC 1000MΩ min
- 4. 耐电压 Dielectric Strength: 1000VAC, 1 Minute
- 5. 操作温度 Operating Temperature: -25°C~ +85°C
- 6. 电气寿命 Electrical Life: ≥10,000 Cycles

选型说明 How to order

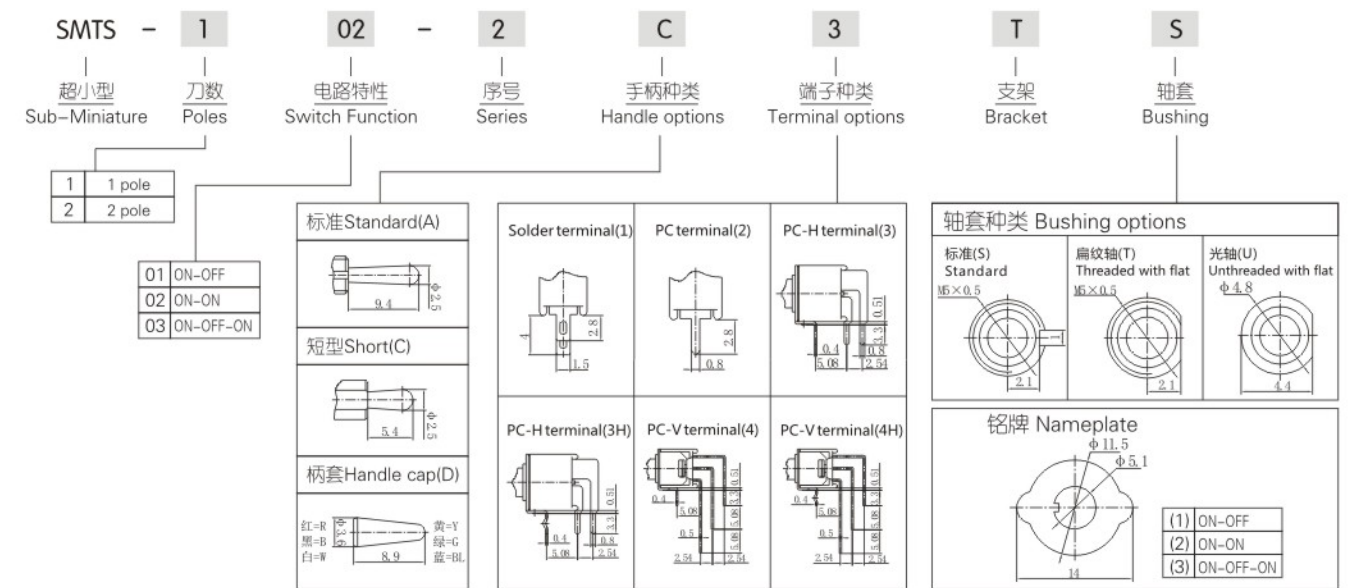

外形尺寸 Dimension



SMTS-101 ON-OFF
SPST 2P

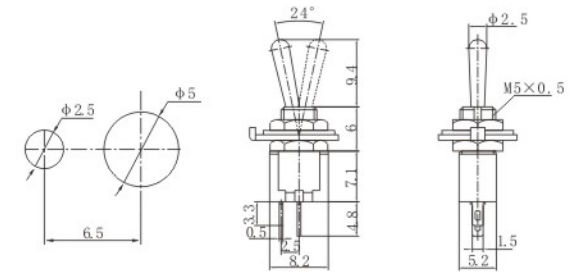

SMTS-102 ON-ON
SPDT 3P

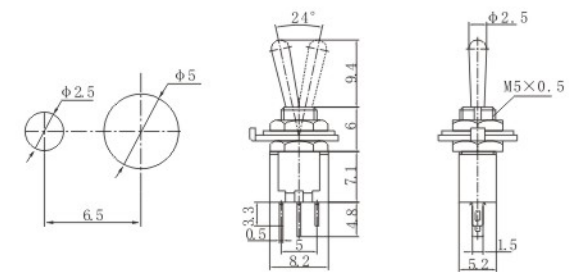



SMTS-202 ON-ON
DPDT 6P

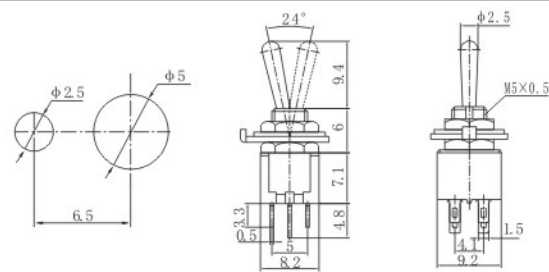

SMTS-102-A2 ON-ON
SPDT 3P

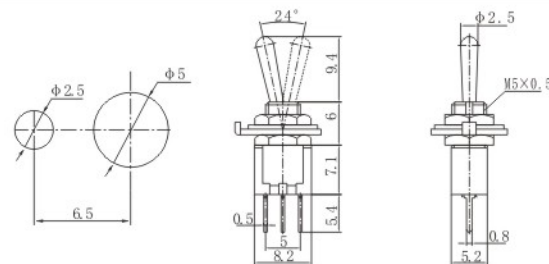

SMTS-202-A2 ON-ON
DPDT 6P

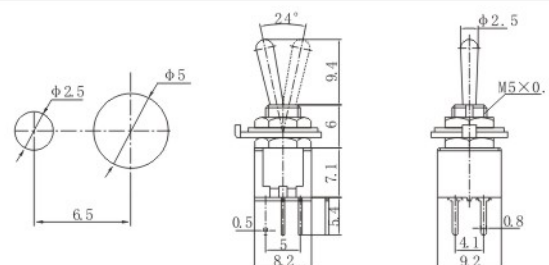

SMTS-103-2A1 ON-OFF-ON
SPDT 3P

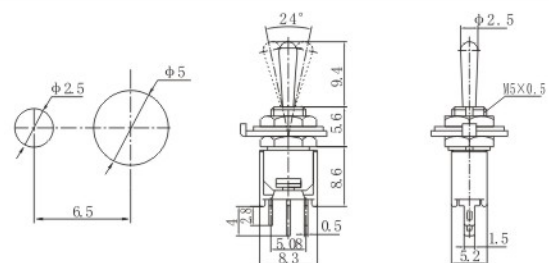

SMTS-203-2A1 ON-OFF-ON
DPDT 6P

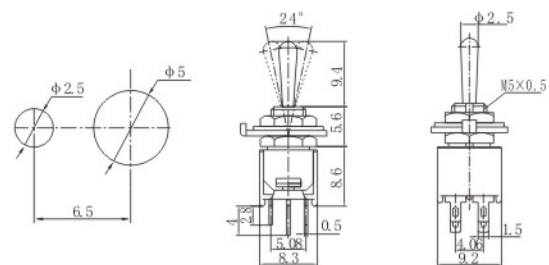

SMTS-102-2C3 ON-ON
SMTS-103-2C3 ON-OFF-ON
SPDT 3P

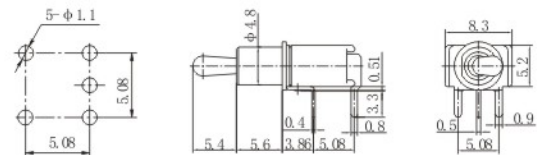

小型钮子开关 Miniature Toggle Switch

技术特性 Specifications

1. 规格 Rating: 6A 125VAC; 3A 250VAC
2. 接触电阻 Contact Resistance: 20mΩ max
3. 绝缘电阻 Insulation Resistance: 500VDC 1000MΩ min
4. 耐电压 Dielectric Strength: 1500VAC, 1 Minute
5. 操作温度 Operating Temperature: -25°C~ +85°C
6. 电气寿命 Electrical Life: ≥10,000 Cycles

选型说明 How to order

MTS - 1 02 - A 1 T - R

小型 Miniature | 刀数 Poles | 电路特性 Switch Function | 手柄种类 Handle options | 端子种类 Terminal options | 支架 Bracket | 底座颜色 Housing color

1	1 pole
2	2 pole
3	3 pole
4	4 pole

01	ON-OFF
02	ON-ON
11	OFF-(ON)
12	ON-(ON)(单复位)
03	ON-OFF-ON
13	ON-OFF-(ON)(单复位)
23	(ON)-OFF-(ON)(双复位)

(): 回弹指示 Indicates Momentary

防水帽 Water proof cap WPC-05	铭牌 Nameplate
----------------------------	--------------

Solder terminal (1)	PC terminal (2)	PC-H terminal (3)	PC-V terminal (4)	Long Solder terminal (5)				
标准 Standard (A)	长型 Long (B)	短型 Short (C)	带柄套 With handle cap (D)	大型 Grand (G)	特大型 Large handle (L)	塑料扁柄 Plastic Flat (E)	金属扁柄 Metal Flat (F)	长金属扁柄 Long Metal Flat (FL)

外形尺寸 Dimension



MTS-101 ON-OFF
MTS-111 OFF-(ON)
SPST 2P

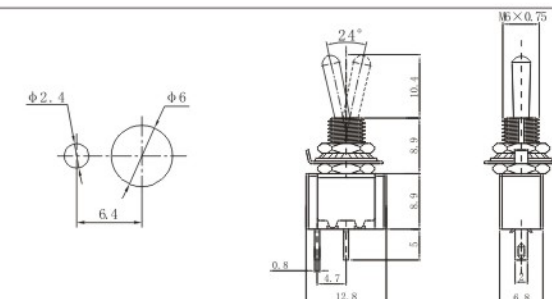

MTS-102 ON-ON
MTS-103 ON-OFF-ON
MTS-112 ON-(ON)
MTS-113 ON-OFF-(ON)
MTS-123 (ON)-OFF-(ON)
SPDT 3P

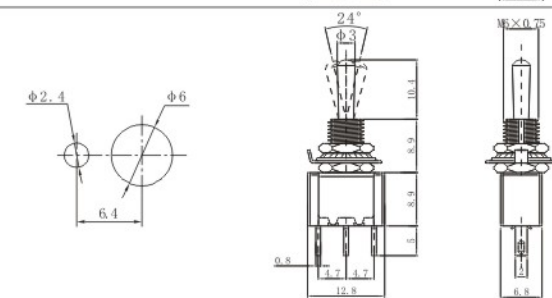



MTS-201 ON-OFF
MTS-211 OFF-(ON)
DPST 4P

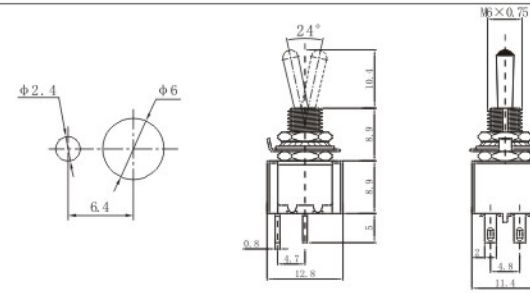

MTS-202 ON-ON
MTS-203 ON-OFF-ON
MTS-2033 ON-ON-ON
MTS-212 ON-(ON)
MTS-213 ON-OFF-(ON)
MTS-223 (ON)-OFF-(ON)
DPDT 6P

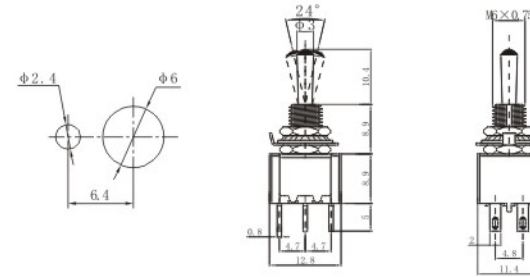

MTS-302 ON-ON
MTS-303 ON-OFF-ON
3PDT 9P

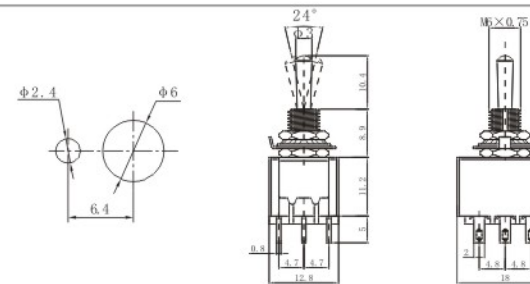

MTS-402 ON-ON
MTS-403 ON-OFF-ON
4PDT 12P

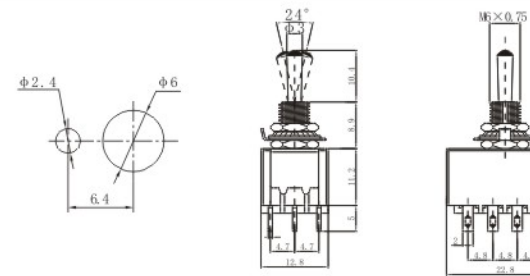

MTS-101-A2 ON-OFF
MTS-111-A2 OFF-(ON)
SPST 2P

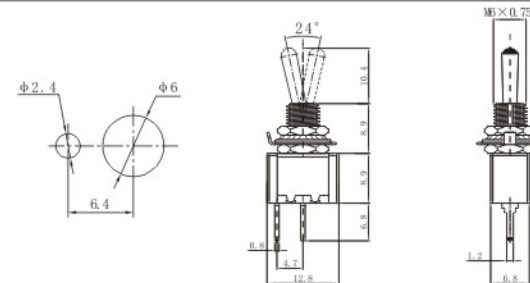

MTS-102-A2 ON-ON
MTS-103-A2 ON-OFF-ON
MTS-112-A2 ON-(ON)
MTS-113-A2 ON-OFF-(ON)
MTS-123-A2 (ON)-OFF-(ON)
SPDT 3P

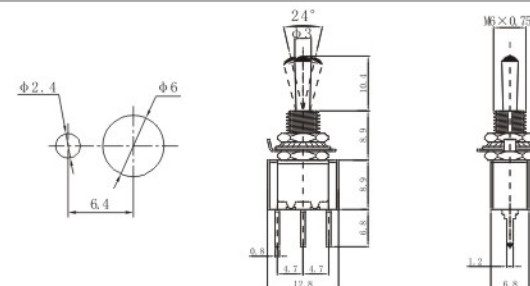

MTS-202-A2 ON-ON
MTS-203-A2 ON-OFF-ON
MTS-212-A2 ON-(ON)
MTS-213-A2 ON-OFF-(ON)
MTS-223-A2 (ON)-OFF-(ON)
DPDT 6P

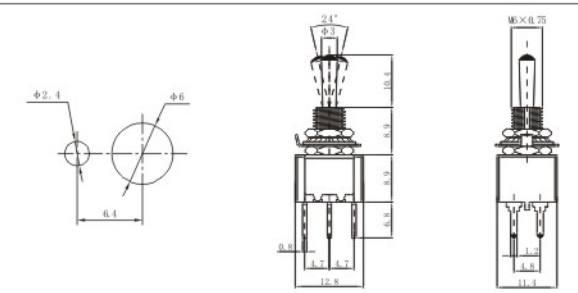

MTS-302-A2 ON-ON
MTS-303-A2 ON-OFF-ON
3PDT 9P

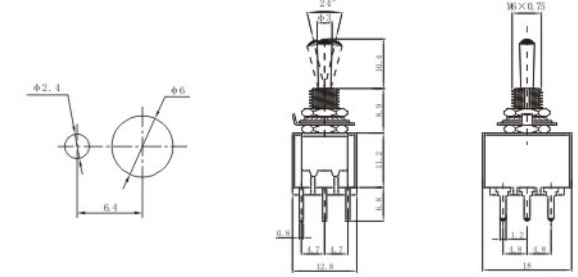

MTS-402-A2 ON-ON
MTS-403-A2 ON-OFF-ON
4PDT 12P

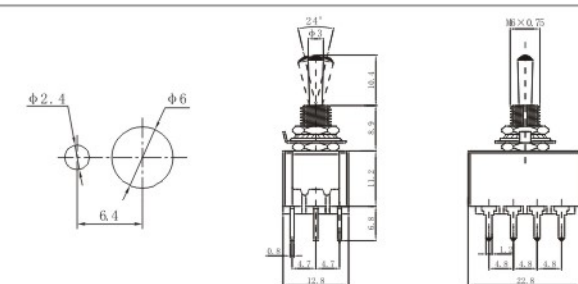

MTS-102-L1 ON-ON
MTS-103-L1 ON-OFF-ON
SPDT 3P

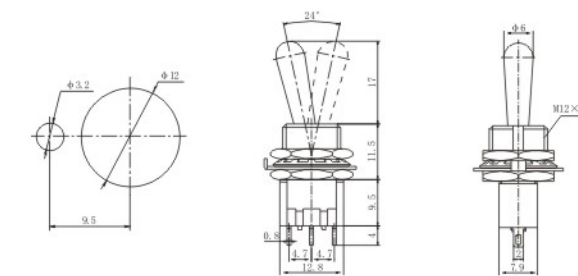

MTS-202-L1 ON-ON
MTS-203-L1 ON-OFF-ON
DPDT 6P

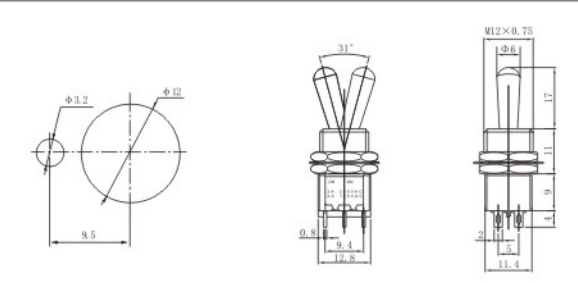

MTS-102-A2T ON-ON
MTS-112-A2T ON-(ON)
MTS-103-A2T ON-OFF-ON
MTS-113-A2T ON-OFF-(ON)
MTS-123-A2T (ON)-OFF-(ON)
SPDT 3P

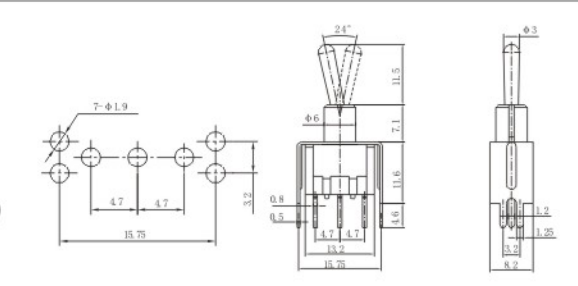



MTS-202-A2T ON-ON
 MTS-212-A2T ON-(ON)
 MTS-203-A2T ON-OFF-ON
 MTS-213-A2T ON-OFF-(ON)
 MTS-223-A2T (ON)-OFF-(ON)
 DPDT 6P

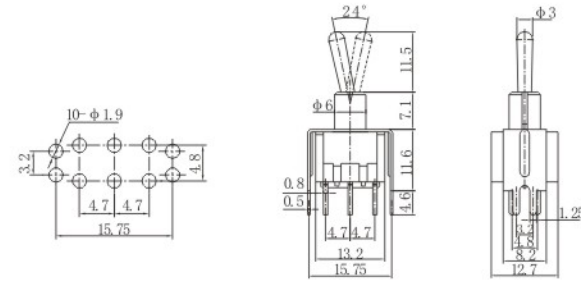

MTS-102-C3 ON-ON
 MTS-112-C3 ON-(ON)
 MTS-103-C3 ON-OFF-ON
 MTS-113-C3 ON-OFF-(ON)
 MTS-123-C3 (ON)-OFF-(ON)
 SPDT 3P

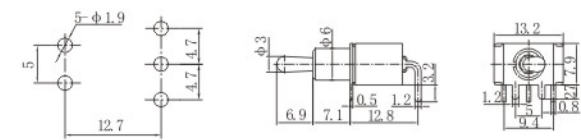

MTS-202-C3 ON-ON
 MTS-212-C3 ON-(ON)
 MTS-203-C3 ON-OFF-ON
 MTS-213-C3 ON-OFF-(ON)
 MTS-223-C3 (ON)-OFF-(ON)
 DPDT 6P

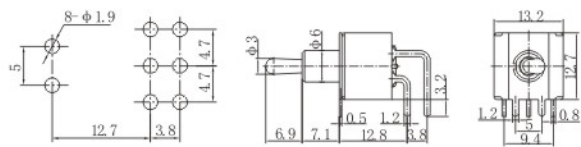

MTS-102-C4 ON-ON
 MTS-112-C4 ON-(ON)
 MTS-103-C4 ON-OFF-ON
 MTS-113-C4 ON-OFF-(ON)
 MTS-123-C4 (ON)-OFF-(ON)
 SPDT 3P

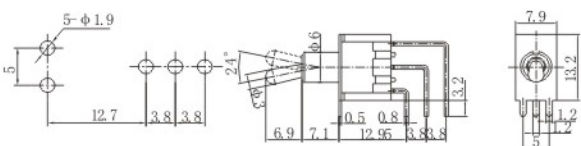

MTS-202-C4 ON-ON
 MTS-212-C4 ON-(ON)
 MTS-203-C4 ON-OFF-ON
 MTS-213-C4 ON-OFF-(ON)
 MTS-223-C4 (ON)-OFF-(ON)
 DPDT 6P

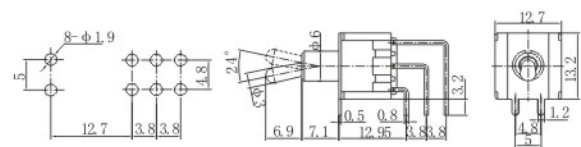

MTS-102-E1 ON-ON
 MTS-112-E1 ON-(ON)
 MTS-103-E1 ON-OFF-ON
 MTS-113-E1 ON-OFF-(ON)
 MTS-123-E1 (ON)-OFF-(ON)
 SPDT 3P
 (PLASTIC FLAT LEVER)

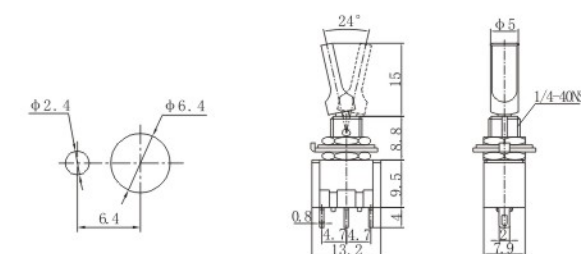

MTS-202-E1 ON-ON
 MTS-212-E1 ON-(ON)
 MTS-203-E1 ON-OFF-ON
 MTS-213-E1 ON-OFF-(ON)
 MTS-223-E1 (ON)-OFF-(ON)
 DPDT 6P
 (PLASTIC FLAT LEVER)

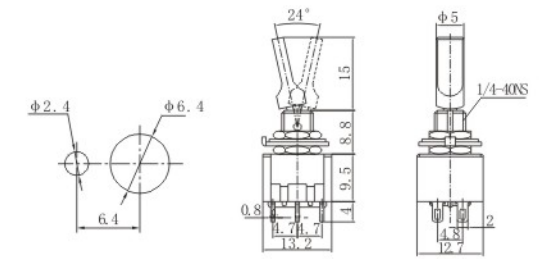

MTS-102-F1 ON-ON
 MTS-112-F1 ON-(ON)
 MTS-103-F1 ON-OFF-ON
 MTS-113-F1 ON-OFF-(ON)
 MTS-123-F1 (ON)-OFF-(ON)
 SPDT 3P
 (METAL FLAT LEVER)

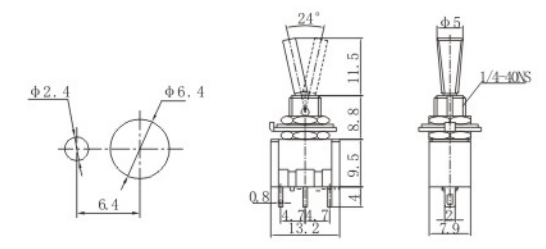

MTS-202-F1 ON-ON
 MTS-212-F1 ON-(ON)
 MTS-203-F1 ON-OFF-ON
 MTS-213-F1 ON-OFF-(ON)
 MTS-223-F1 (ON)-OFF-(ON)
 DPDT 6P
 (METAL FLAT LEVER)

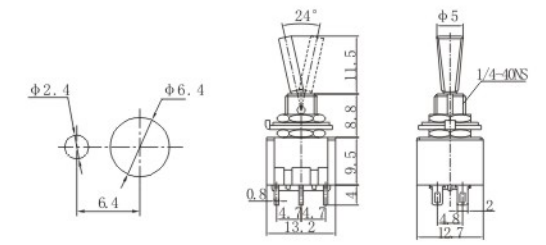

KNX-1-D1 ON-ON
 KNX-103-D1 ON-OFF-ON
 SPDT 3P

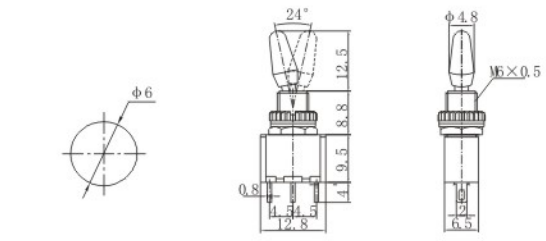

KNX-2-D1 ON-ON
 KNX-203-D1 ON-OFF-ON
 DPDT 6P

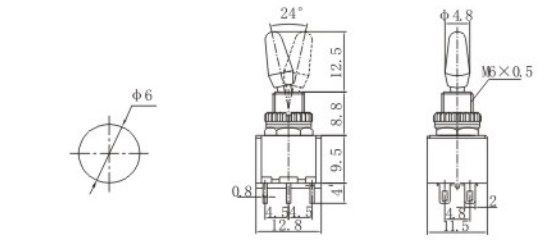

MTS-102-B1 ON-ON
 MTS-112-B1 ON-(ON)
 SPDT 3P

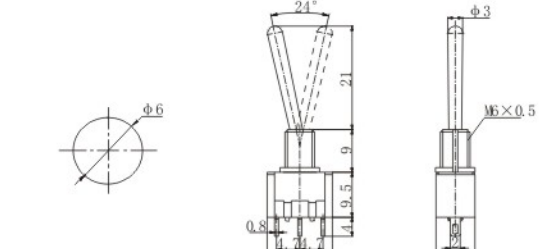

小型摇臂开关 Miniature Rocker Toggle Switch

技术特性 Specifications

- | | |
|--|---|
| 1. 规格 Rating: 6A 125VAC; 3A 250VAC | 4. 耐电压 Dielectric Strength: 1500VAC, 1 Minute |
| 2. 接触电阻 Contact Resistance: 20mΩ max | 5. 操作温度 Operating Temperature: -25°C~ +85°C |
| 3. 绝缘电阻 Insulation Resistance: 500VDC 1000MΩ min | 6. 电气寿命 Electrical Life: ≥10,000 Cycles |

选型说明 How to order

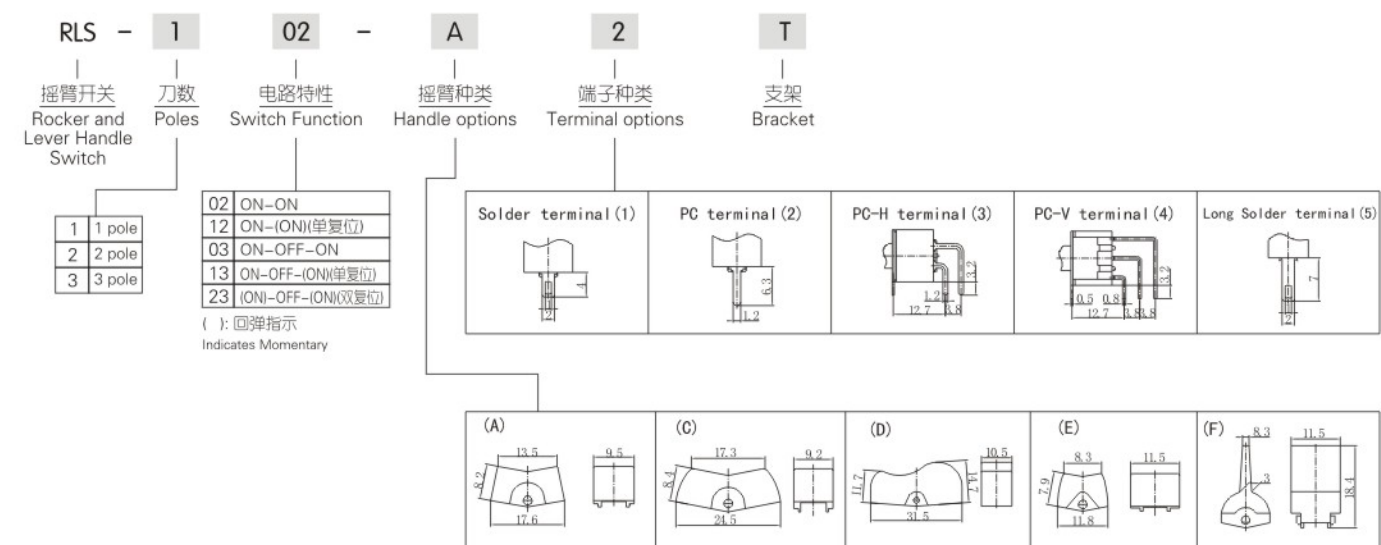

外形尺寸 Dimension

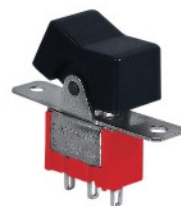

- RLS-102-A1 ON-ON
RLS-112-A1 ON-(ON)
RLS-103-A1 ON-OFF-ON
RLS-113-A1 ON-OFF-(ON)
RLS-123-A1 (ON)-OFF-(ON)
SPDT 3P

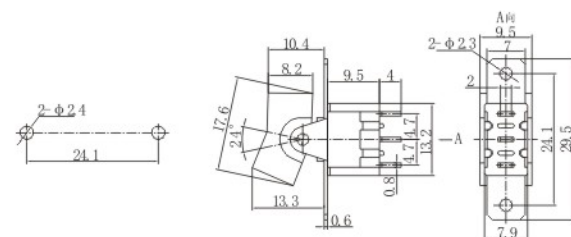

- RLS-202-A1 ON-ON
RLS-212-A1 ON-(ON)
RLS-203-A1 ON-OFF-ON
RLS-213-A1 ON-OFF-(ON)
RLS-223-A1 (ON)-OFF-(ON)
DPDT 6P

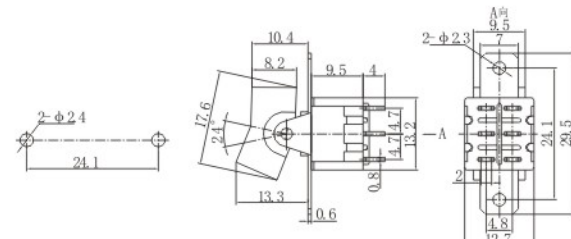

- RLS-102-A3 ON-ON
RLS-112-A3 ON-(ON)
RLS-103-A3 ON-OFF-ON
RLS-113-A3 ON-OFF-(ON)
RLS-123-A3 (ON)-OFF-(ON)
SPDT 3P

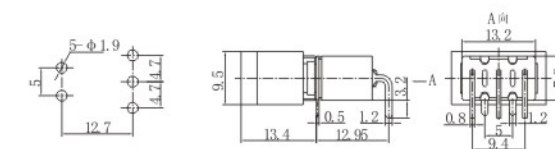

- RLS-202-A3 ON-ON
RLS-212-A3 ON-(ON)
RLS-203-A3 ON-OFF-ON
RLS-213-A3 ON-OFF-(ON)
RLS-223-A3 (ON)-OFF-(ON)
DPDT 6P

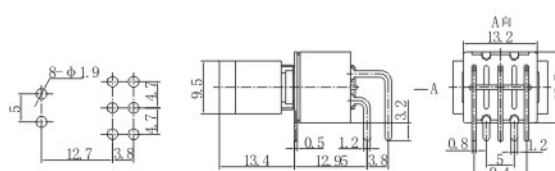

- RLS-102-A4 ON-ON
RLS-112-A4 ON-(ON)
RLS-103-A4 ON-OFF-ON
RLS-113-A4 ON-OFF-(ON)
RLS-123-A4 (ON)-OFF-(ON)
SPDT 3P

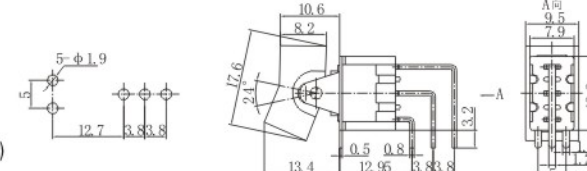

- RLS-202-A4 ON-ON
RLS-212-A4 ON-(ON)
RLS-203-A4 ON-OFF-ON
RLS-213-A4 ON-OFF-(ON)
RLS-223-A4 (ON)-OFF-(ON)
DPDT 6P

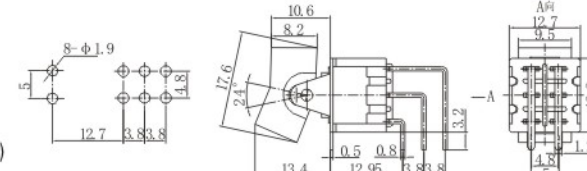

- RLS-102-F1 ON-ON
RLS-112-F1 ON-(ON)
RLS-103-F1 ON-OFF-ON
RLS-113-F1 ON-OFF-(ON)
RLS-123-F1 (ON)-OFF-(ON)
SPDT 3P

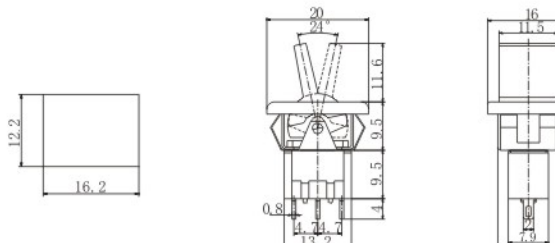

- RLS-202-F1 ON-ON
RLS-212-F1 ON-(ON)
RLS-203-F1 ON-OFF-ON
RLS-213-F1 ON-OFF-(ON)
RLS-223-F1 (ON)-OFF-(ON)
DPDT 6P

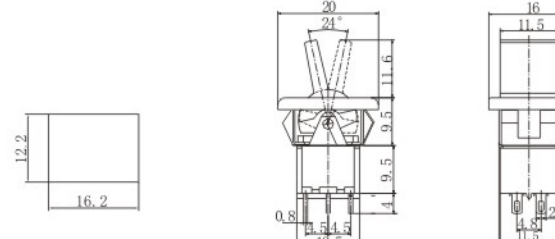

中型钮子开关 Medium Toggle Switch

技术特性 Specifications

- 规格 Rating: ()10A 125VAC;6A 250VAC
(A)15A 125VAC;10A 250VAC
(AA)20A 125VAC;15A 250VAC
- 接触电阻 Contact Resistance: 50mΩ max
- 绝缘电阻 Insulation Resistance: 500VDC 1000MΩ Min
- 耐电压 Dielectric Strength: 1500VAC, 1Minute
- 操作温度 Operating Temperature: -25℃~ +85℃
- 电气寿命 Electrical Life: ≥10,000 Cycles

选型说明 How to order

KN3 C	-	1	02	A	P	E	-	BN
钮子外壳类型 Housing shape		刀数 Poles	电路特性 Switch Function	规格 Rating	端子种类 Terminal options	手柄种类 Handle options		底座颜色 Housing color
A B C D E		1 1 pole 2 2 pole 3 3 pole 4 4 pole	01 ON-OFF 02 ON-ON 11 OFF-(ON) 12 ON-(ON)(单复位) 03 ON-OFF-ON 13 ON-OFF-(ON)(单复位) 23 (ON)-OFF-(ON)(双复位)	() Screw Terminal () PC Terminal (P)	(S) Solder Terminal (S) Press Terminal (T)	() (D) (E) (C) (L)		BK 黑色 Black BN 棕色 Brown OG 橘黄 Orange
			() : 回弹指示 Indicates Momentary	(R) Hitch Terminal (R)				

防水帽 Water proof cap

WPC-06 M12X0.75 M12X1.0		WPC-08 M12X0.75 M12X1.0		WPC-11 M12X0.75		WPC-12 M12X0.75	
-------------------------------	--	-------------------------------	--	--------------------	--	--------------------	--



KN3C-101 ON-OFF
KN3C-111 OFF-(ON)
SPST 2P

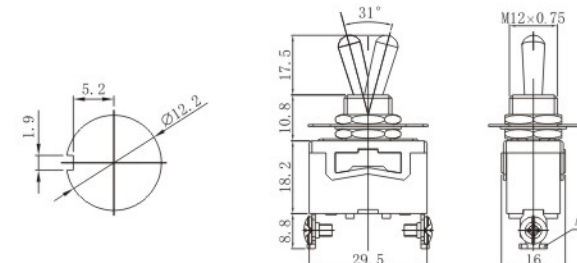

KN3C-102 ON-ON
KN3C-112 ON-(ON)
KN3C-103 ON-OFF-ON
KN3C-113 ON-OFF-(ON)
KN3C-123 (ON)-OFF-(ON)
SPDT 3P

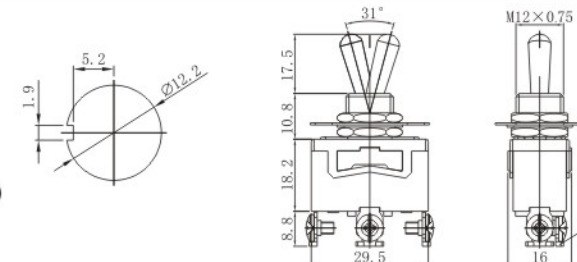

KN3C-201 ON-OFF
KN3C-211 OFF-(ON)
DPST 4P

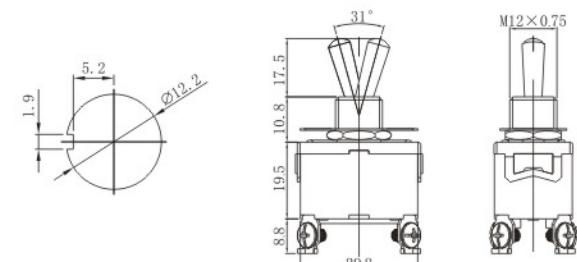

KN3C-202 ON-ON
KN3C-212 ON-(ON)
KN3C-203 ON-OFF-ON
KN3C-213 ON-OFF-(ON)
KN3C-223 (ON)-OFF-(ON)
DPDT 6P

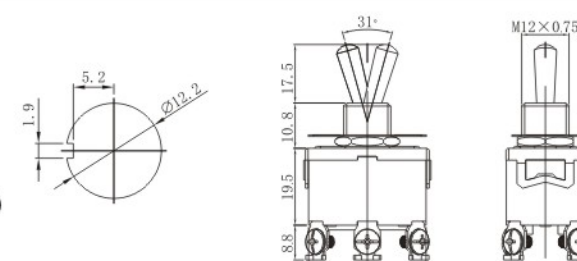

KN3C-302 ON-ON
KN3C-303 ON-OFF-ON
3PDT 9P

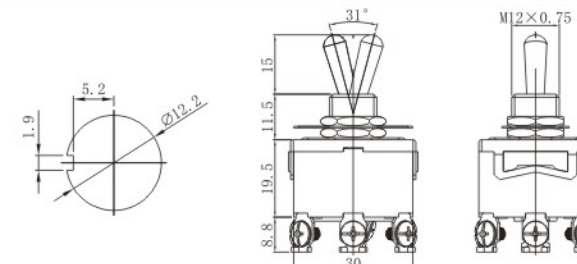

KN3C-402 ON-ON
KN3C-403 ON-OFF-ON
4PDT 12P

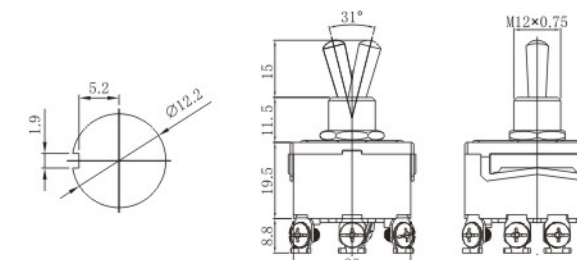



KN3C-101P ON-OFF
KN3C-111P OFF-(ON)
SPST 2P

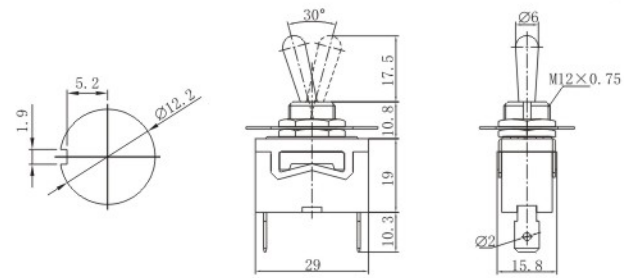

KN3C-102P ON-ON
KN3C-112P ON-(ON)
KN3C-103P ON-OFF-ON
KN3C-113P ON-OFF-(ON)
KN3C-123P (ON)-OFF-(ON)
SPDT 3P

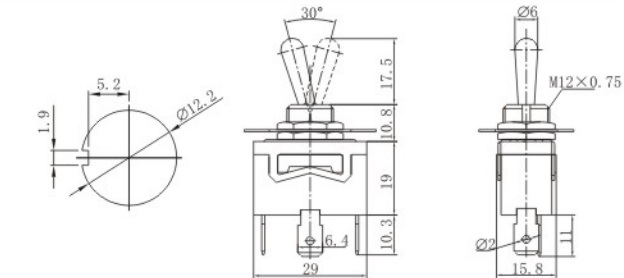

KN3C-201P ON-OFF
KN3C-211P OFF-(ON)
DPST 4P

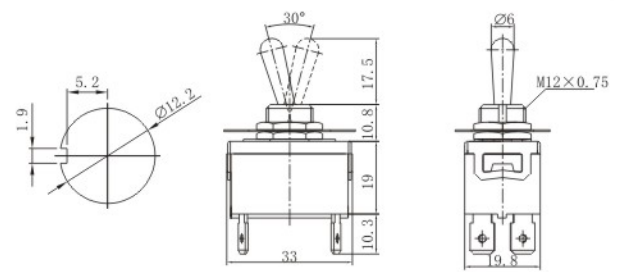

KN3C-202P ON-ON
KN3C-212P ON-(ON)
KN3C-203P ON-OFF-ON
KN3C-213P ON-OFF-(ON)
KN3C-223P (ON)-OFF-(ON)
DPDT 6P

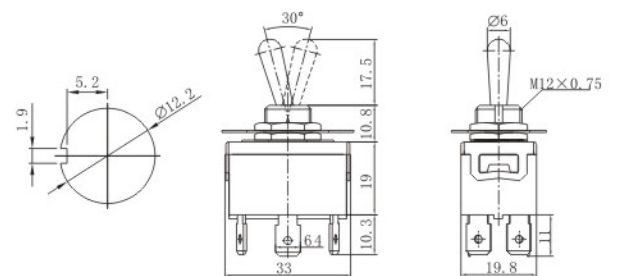

KN3C-302P ON-ON
KN3C-303P ON-OFF-ON
3PDT 9P

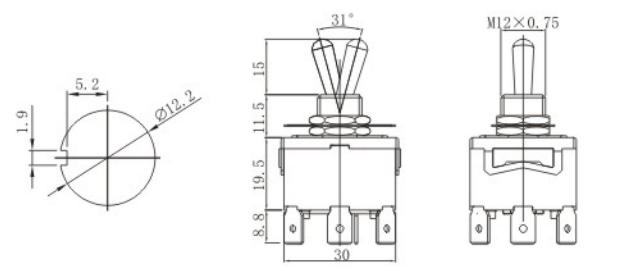

KN3C-402P ON-ON
KN3C-403P ON-OFF-ON
4PDT 12P

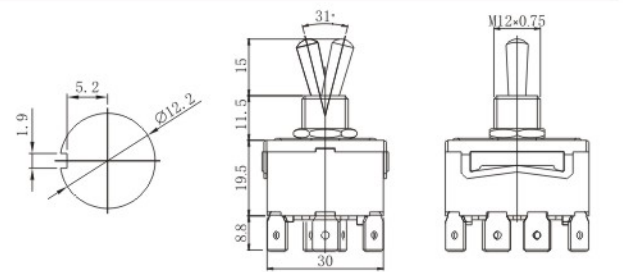

KN3C-202E ON-ON
KN3C-212E ON-(ON)
KN3C-203E ON-OFF-ON
KN3C-213E ON-OFF-(ON)
KN3C-223E (ON)-OFF-(ON)
DPDT 6P

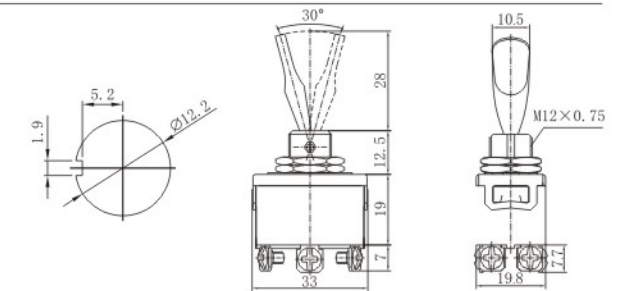

KN3A-101 ON-OFF
SPST 2P

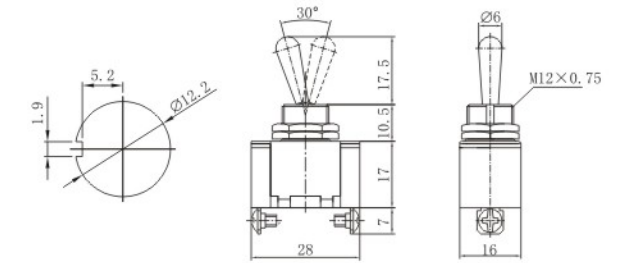

KN3A-102 ON-ON
KN3A-112 ON-(ON)
KN3A-103 ON-OFF-ON
KN3A-113 ON-OFF-(ON)
KN3A-123 (ON)-OFF-(ON)
SPDT 3P

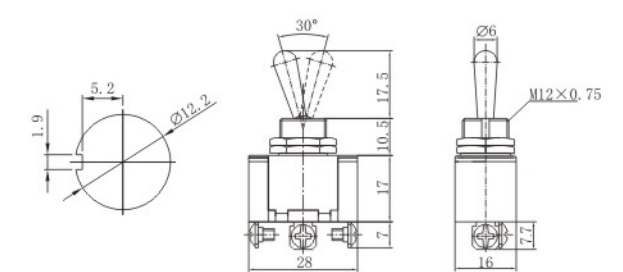

KN3A-101P ON-OFF
SPST 2P

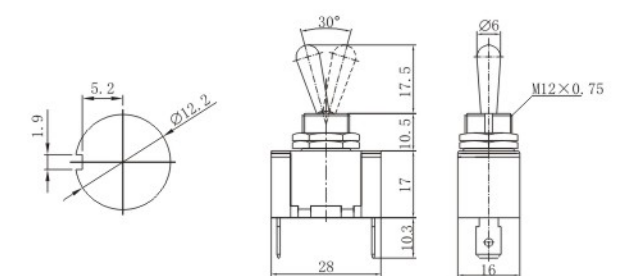

KN3A-102P ON-ON
KN3A-112P ON-(ON)
KN3A-103P ON-OFF-ON
KN3A-113P ON-OFF-(ON)
KN3A-123P (ON)-OFF-(ON)
SPDT 3P

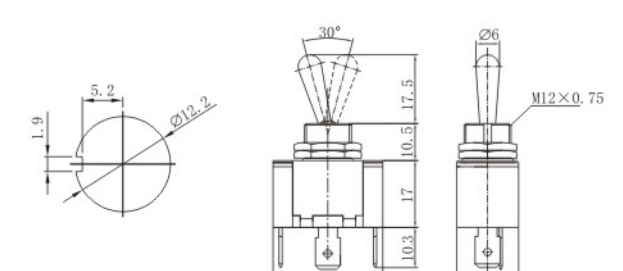

KN3B-101 ON-OFF
SPST 2P

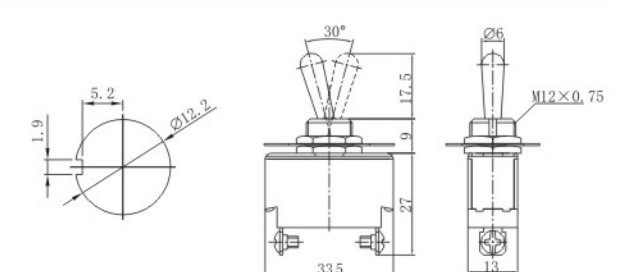



KN3B-102 ON-ON
KN3B-112 ON-(ON)
KN3B-103 ON-OFF-ON
KN3B-113 ON-OFF-(ON)
KN3B-123 (ON)-OFF-(ON)
SPDT 3P

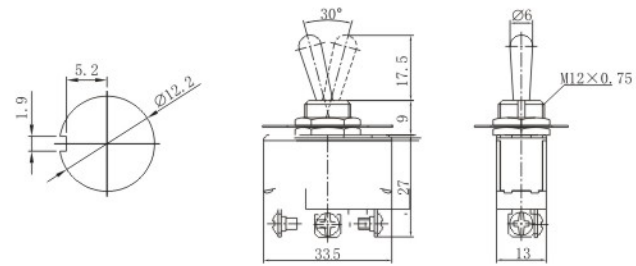

KN3B-201 ON-OFF
DPST 4P

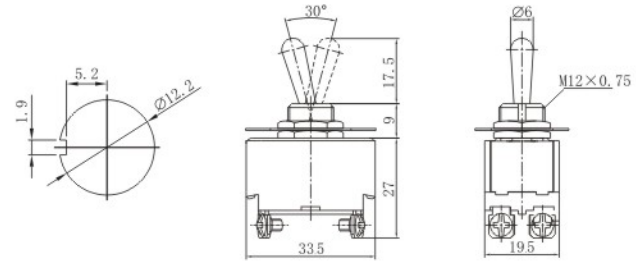

KN3B-202 ON-ON
KN3B-212 ON-(ON)
KN3B-203 ON-OFF-ON
KN3B-213 ON-OFF-(ON)
KN3B-223 (ON)-OFF-(ON)
DPDT 6P

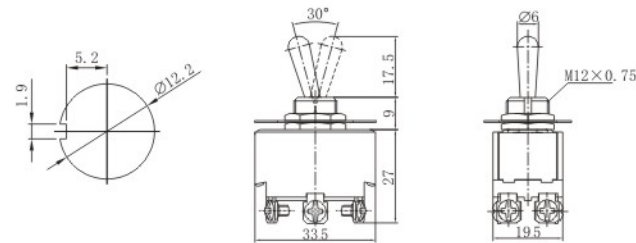

KN-32 ON-ON
DPDT 6P
10A 125VAC; 5A 250VAC

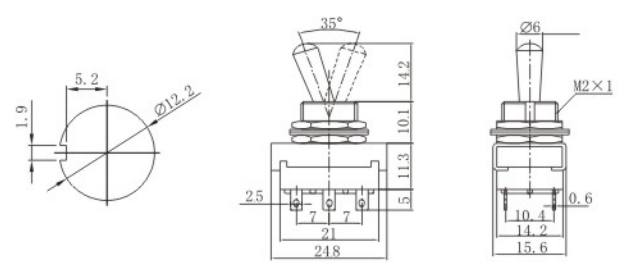

KN3-3A ON-ON
DPDT 6P
6A 125VAC; 3A 250VAC

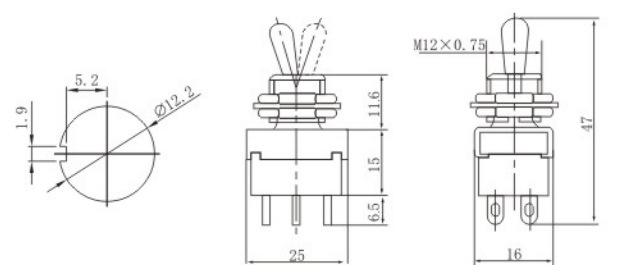

KN3-1 ON-OFF
SPST 2P
4A 125VAC; 2A 250VAC

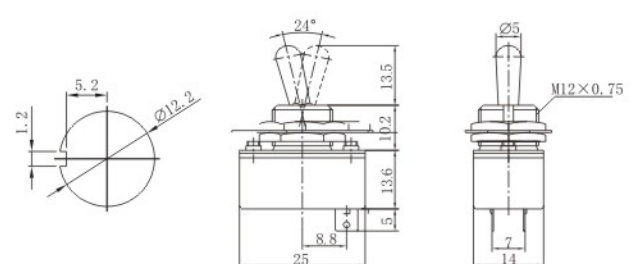

KN3-2 ON-ON
SPDT 4P
4A 125VAC; 2A 250VAC

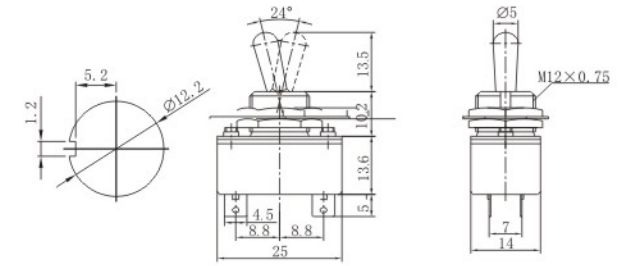

KN3-3 ON-ON
DPDT 6P
5A 125VAC; 3A 250VAC

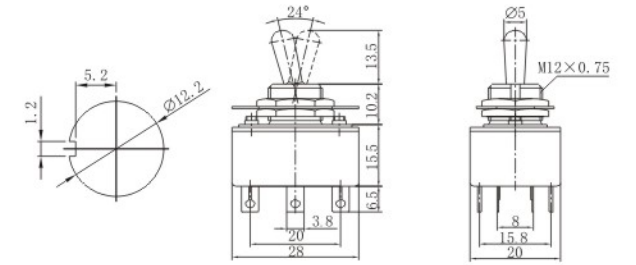

KNS-1 ON-OFF
SPST 2P
6A 125VAC; 3A 250VAC; 10A 12VDC

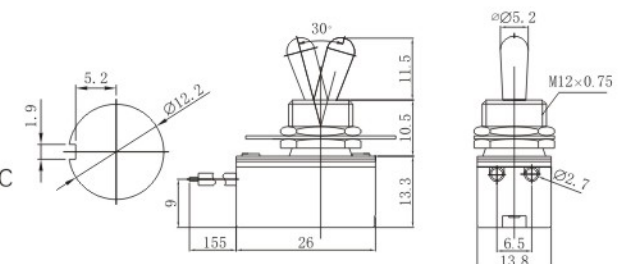

KNS-2 ON-OFF
SPST 2P
6A 125VAC; 3A 250VAC; 10A 12VDC

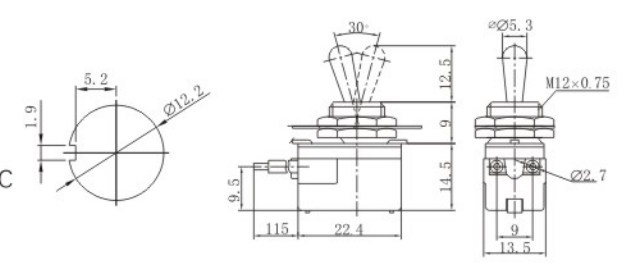

KNH-1 ON-OFF
SPST 2P
6A 125VAC; 3A 250VAC; 10A 12VDC

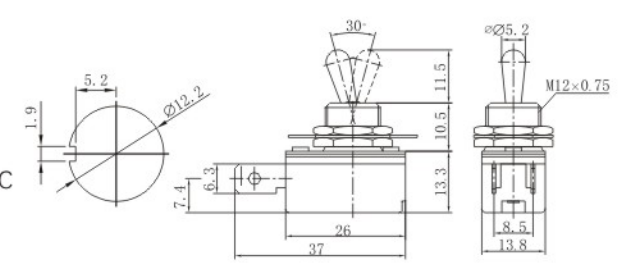

KNH-1S ON-OFF
SPST 2P(Screw Terminals)
6A 125VAC; 3A 250VAC; 10A 12VDC

